

100 SERIES (NON-EJECTOR) WATER COOLED ELECTRODE HOLDER

100 SERIES TAPERED HOLDER					
Part No. Holder Assy.	Major Taper Dia. A	Barrel Dia. B	Barrel Length C	RW Taper D	Engagement With Std. Elect. E
18-101 18-102 18-103 18-104	.463	3/4 7/8 1 1-1/4	3	4 RW	1/2
18-106 18-107 18-108	.625	1 1-1/4 1-1/2		5 RW	3/4
18-111 18-112 18-113 18-114	.463	3/4 7/8 1 1-1/4	8	4 RW	1/2
18-116 18-117 18-118	.625	1 1-1/4 1-1/2		5 RW	3/4
18-119 18-120	.875	1-1/4 1-1/2		7 RW	1-1/8
18-131 18-132 18-133 18-134	.463	3/4 7/8 1 1-1/4	12	4 RW	1/2
18-136 18-137 18-138	.625	1 1-1/4 1-1/2		5 RW	3/4

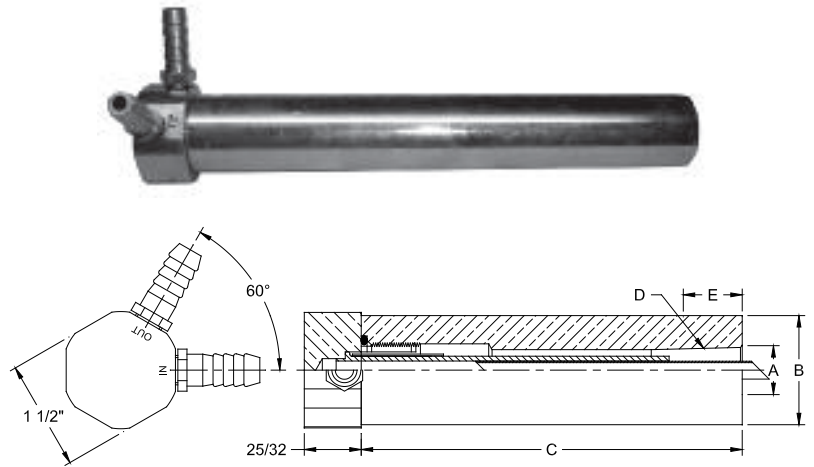

100 SERIES THREADED HOLDER				
Part No. Holder Assy.	Barrel Dia. B	Barrel Length C	Thread Size D	Engagement With Std. Electrode E
18-169 18-170 18-171	1 1-1/4 1-1/2	8	5/8-18	9/16
18-172 18-173 18-174	1 1-1/4 1-1/2		7/8-14	9/16
18-175 18-176	1-1/4 1-1/2		1-14	3/4

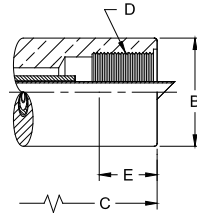

See available adapters in table below.

ADAPTERS USED WITH THREADED HOLDERS

100 SERIES THREADED HOLDER ADAPTERS					
Holder Assembly No.	Adapter Part No.	Page No.	Attachment Description		
18-169 18-170 18-171	18-750	31	4 RW Female		
	18-751	31	5 RW Female		
	18-752	31	5/8-18 M. Thread		
	18-811	50	#1 Size Nu-Twist®		
18-172 18-173 18-174	18-770	31	4 RW Female	May also be used with universal Adapters having 7/8-14 Male thread See page 46	
	18-771	31	5 RW Female		
18-175 18-176	18-785	31	4 RW Female	May also be used with universal Adapters having 1-14 Male thread See page 46	
	18-786	31	5 RW Female		
	18-7863	31	6 RW Female		
	18-787	31	7 RW Female		
	18-812	50	#2 Size Nu-Twist®		

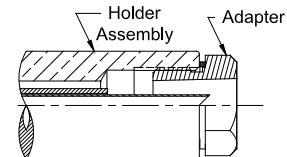
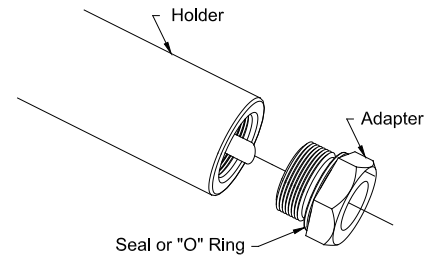

100 SERIES (NON-EJECTOR) REPLACEMENT PARTS

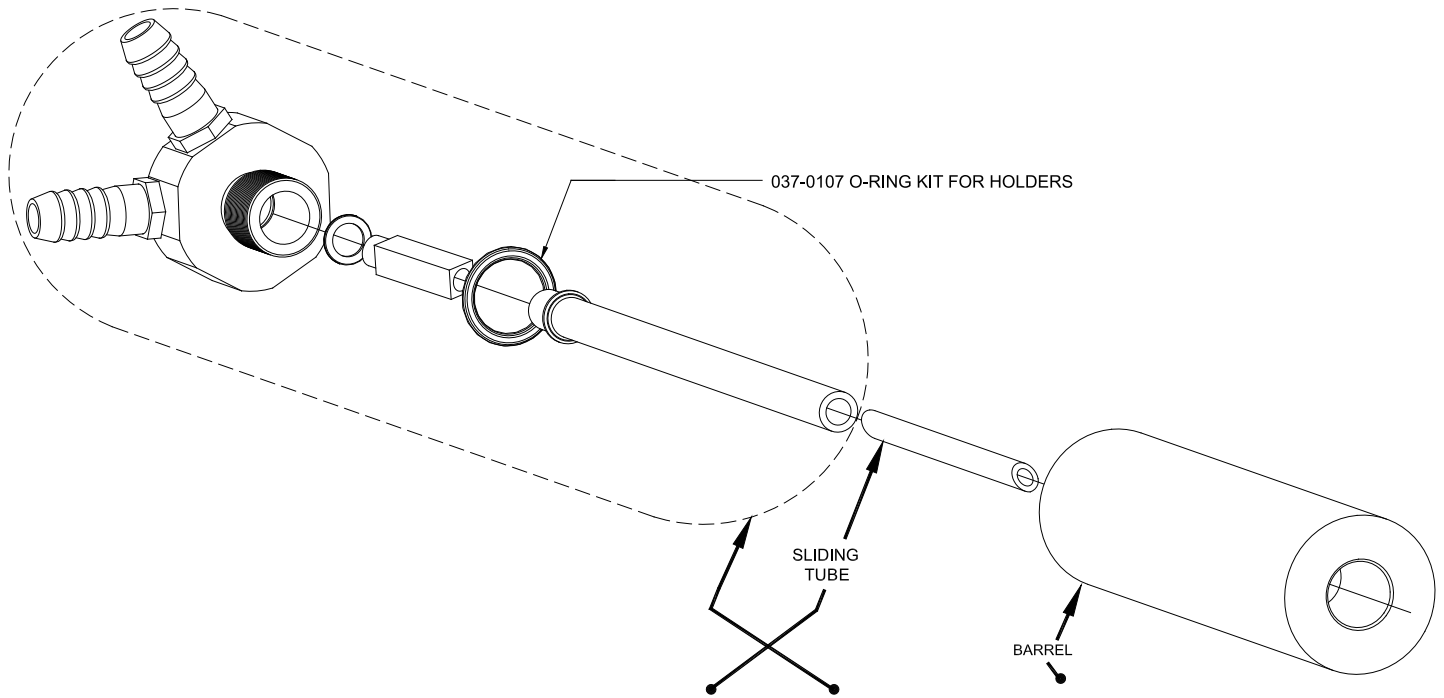

Part No. Holder Assy.	Thread Or Taper	Barrel Length	Sliding Tube	Water Conn. HD. Sub-Assy.	Barrel Diameter	Barrel
18-101 18-102 18-103 18-104	4 RW	3	18-10046-3	18-10093-5 18-10093-5 18-10091-3 18-10091-3	3/4 7/8 1 1-1/4	18-11110-3 18-11210-3 18-11310-3 18-11410-3
18-106 18-107 18-108	5 RW	3	18-10047-3	18-10092-3	1 1-1/4 1-1/2	18-11610-3 18-11710-3 18-11810-3
18-111 18-112 18-113 18-114	4 RW	8	18-10046-8	18-10093-8 18-10093-8 18-10091-8 18-10091-8	3/4 7/8 1 1-1/4	18-11110-8 18-11210-8 18-11310-8 18-11410-8
18-116 18-117 18-118	5 RW	8	18-10047-8	18-10092-8	1 1-1/4 1-1/2	18-11610-8 18-11710-8 18-11810-8
18-119 18-120	7 RW	8	18-10047-8	18-10092-8	1-1/4 1-1/2	18-11910-8 18-12010-8
18-131 18-132 18-133 18-134	4 RW	12	18-10046-8	18-10093-12 18-10093-12 18-10091-12 18-10091-12	3/4 7/8 1 1-1/4	18-11110-12 18-11210-12 18-11310-12 18-11410-12
18-136 18-137 18-138	5 RW	12	18-10047-8	18-10092-12	1 1-1/4 1-1/2	18-11610-12 18-11710-12 18-11810-12
18-169 18-170 18-171	5/8-18	8	18-10047-8	18-10092-8	1 1-1/4 1-1/2	18-16910-8 18-17010-8 18-17110-8
18-172 18-173 18-174	7/8-14	8	18-10047-8	18-10092-8	1 1-1/4 1-1/2	18-17210-8 18-17310-8 18-17410-8
18-175 18-176	1-14	8	18-10047-8	18-10092-8	1-1/4 1-1/2	18-17510-8 18-17610-8

200 SERIES (EJECTOR) WATER COOLED ELECTRODE HOLDER

200 SERIES TAPERED HOLDER					
Part No. Holder Assy.	Major Taper Dia. A	Barrel Dia. B	Barrel Length C	RW Taper D	Engagement With Std. Elect. E
18-201	.463	3/4	3	4 RW	1/2
18-202		7/8			
18-203		1			
18-204		1-1/4			
18-206	.625	1	8	5 RW	3/4
18-207		1-1/4			
18-208		1-1/2			
18-211	.463	3/4	12	4 RW	1/2
18-212		7/8			
18-213		1			
18-214		1-1/4			
18-216	.625	1	8	5 RW	3/4
18-217		1-1/4			
18-218		1-1/2			
18-219*	.875	1-1/4	18	5 RW	1-1/8
18-220*		1-1/2			
18-231	.463	3/4	12	4 RW	1/2
18-232		7/8			
18-233		1			
18-234		1-1/4			
18-236	.625	1	18	5 RW	3/4
18-237		1-1/4			
18-238		1-1/2			
18-236-18	.625	1	18	5 RW	3/4
18-237-18		1-1/4			
18-238-18		1-1/2			

*Must use knockout adapter 18-20033

200 SERIES THREADED HOLDER				
Part No. Holder Assy.	Barrel Dia. B	Barrel Length C	Thread Size D	Engagement With Std. Elect. E
18-272	1	8	7/8-14	9/16
18-273	1-1/4			
18-274	1-1/2			
18-275	1-1/4	8	1-14	3/4
18-276	1-1/2			

200 Series Threaded Holder can use Male Threaded to Female Taper Universal Adapters on page 46.

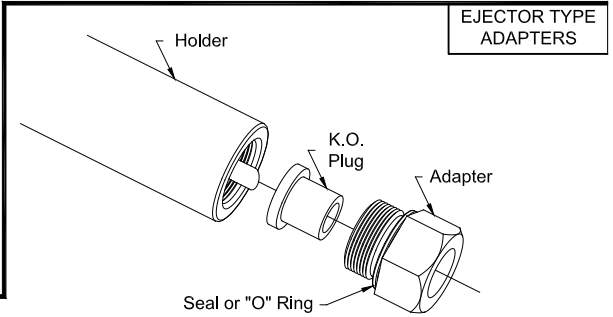
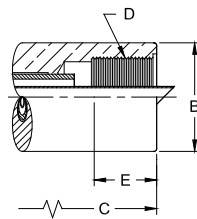
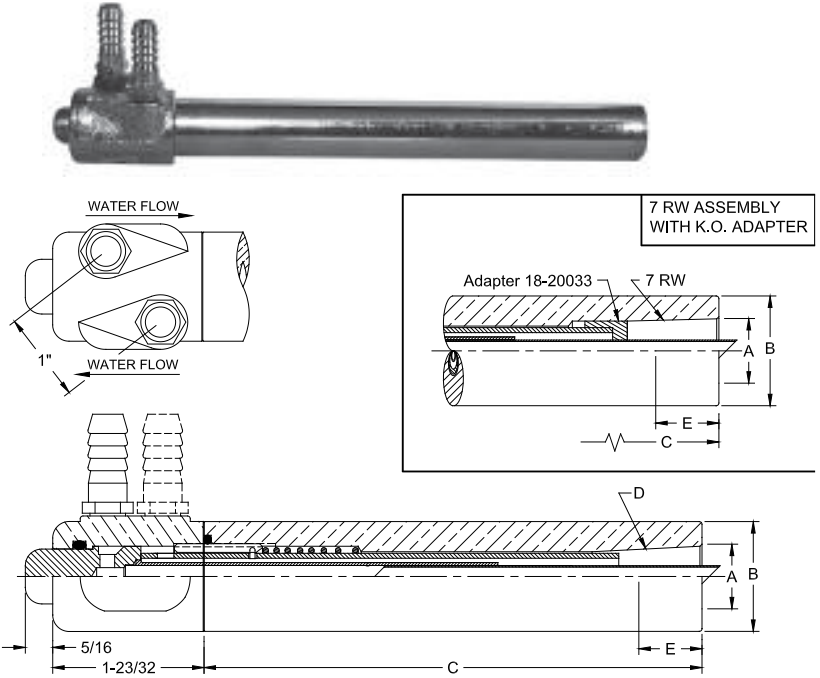

EJECTOR TYPE ADAPTERS

EJECTOR TYPE ADAPTERS 7/8-14 THREAD								
Adapter Part No.	Male Thd. Size L	Female Taper		Length Under Hd. M	Hex. Over Flats H	Overall Length C	Sealing Ring Part No.	K.O. Plug Part No.
		Size D	Major Dia. A					
18-7702	7/8-14	4 RW	.463	5/8	1	13/16	18-76460	18-78501
18-7712	7/8-14	5 RW	.625	1/2	1	1-1/16	18-76460	18-7712-3

Use with Threaded Ejector Holder to make Replaceable Taper Holders

Part No.	Female Thd. Size	Barrel Dia.
18-272	7/8-14	1
18-273	7/8-14	1-1/4
18-274	7/8-14	1-1/2

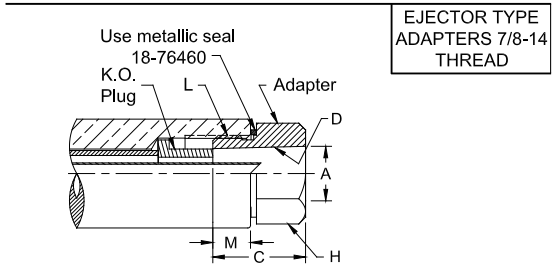

EJECTOR TYPE ADAPTERS 1-14 THREAD								
Adapter Part No.	Male Thd. Size L	Female Taper		Length Under Hd. M	Hex. Over Flats H	Overall Length C	Sealing Ring Part No.	K.O. Plug Part No.
		Size D	Major Dia. A					
18-7852	1-14	4 RW	.463	9/16	1-1/4	13/16	18-10060-17	18-78501
18-7862	1-14	5 RW	.625	7/16	1-1/4	1-1/16	18-10060-17	18-7712-3
18-7864	1-14	6 RW	.750	3/4	1-1/4	1-3/4	18-10060-17	18-78650
18-7872	1-14	7 RW	.875	3/4	1-1/4	2-1/8	18-10060-17	18-78701

Use with Threaded Ejector Holder to make Replaceable Taper Holders

Part No.	Female Thd. Size	Barrel Dia.
18-275	1-14	1-1/4
18-276	1-14	1-1/2

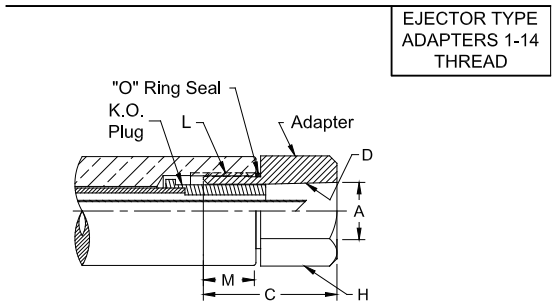

200 SERIES (EJECTOR) REPLACEMENT PARTS

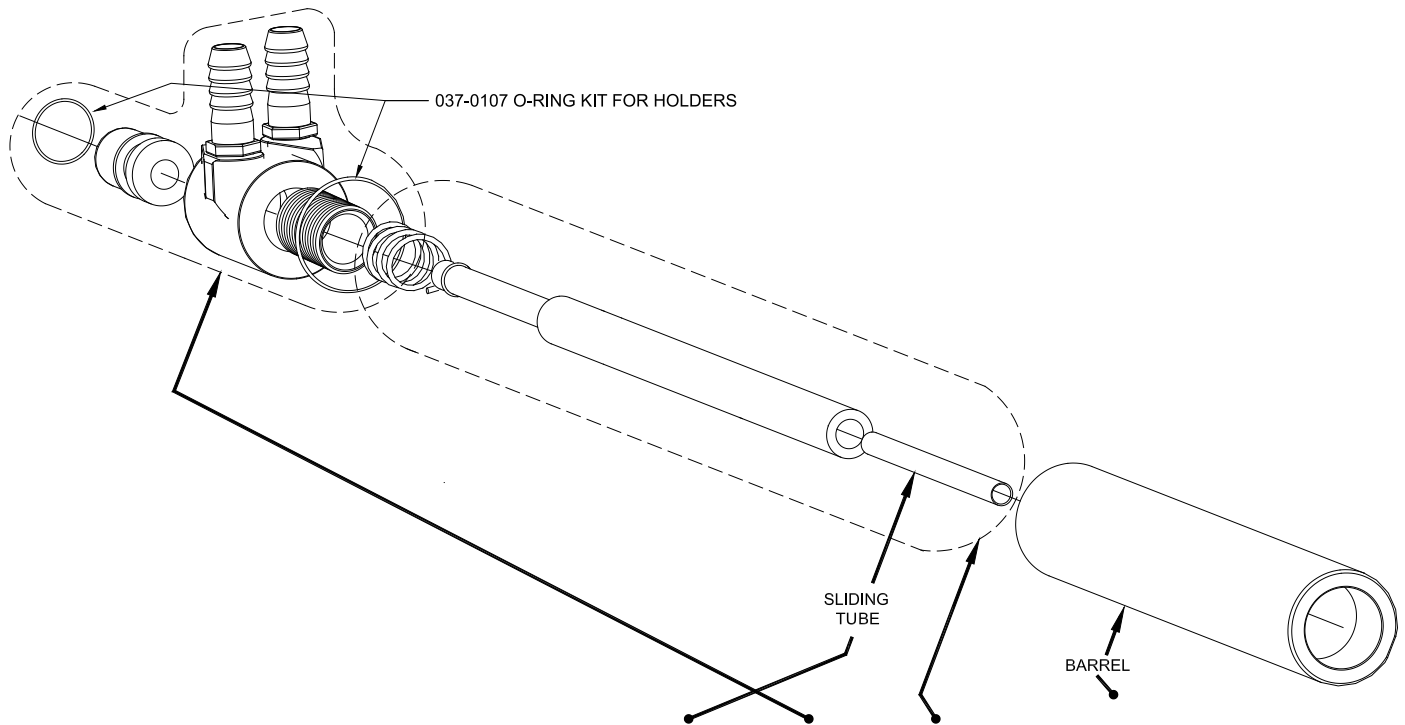

Part No. Holder Assy.	Thread Or Taper	Barrel Length	Sliding Tube	Water Conn. HD. Sub-Assy.	K.O. Tube Sub-Assy	Barrel Diameter	Barrel
18-201 18-202 18-203 18-204	4 RW	3	18-10046-3	18-20093 18-20093 18-20091 18-20091	18-20095-3	3/4 7/8 1 1-1/4	18-11110-3 18-11210-3 18-11310-3 18-11410-3
18-206 18-207 18-208	5 RW	3	18-10047-3	18-20092	18-20096-3	1 1-1/4 1-1/2	18-11610-3 18-11710-3 18-11810-3
18-211 18-212 18-213 18-214	4 RW	8	18-10046-8	18-20093 18-20093 18-20091 18-20091	18-20095-8	3/4 7/8 1 1-1/4	18-11110-8 18-11210-8 18-11310-8 18-11410-8
18-216 18-217 18-218	5 RW	8	18-10047-8	18-20092	18-20096-8	1 1-1/4 1-1/2	18-11610-8 18-11710-8 18-11810-8
18-219* 18-220*	7 RW	8	18-10047-8	18-20092	18-20096-58	1-1/4 1-1/2	18-11910-8 18-12010-8
18-231 18-232 18-233 18-234	4 RW	12	18-10046-8	18-20093 18-20093 18-20091 18-20091	18-20095-12	3/4 7/8 1 1-1/4	18-11110-12 18-11210-12 18-11310-12 18-11410-12
18-236 18-237 18-238	5 RW	12	18-10047-8	18-20092	18-20096-12	1 1-1/4 1-1/2	18-11610-12 18-11710-12 18-11810-12
18-236-18 18-237-18 18-238-18	5 RW	18	18-10047-29	18-20092	18-20096-18	1 1-1/4 1-1/2	18-11610-18 18-11710-18 18-11810-18
18-272 18-273 18-274	7/8-14	8	18-10047-8	18-20092	18-20096-8	1 1-1/4 1-1/2	18-17210-8 18-17310-8 18-17410-8
18-275 18-276	1-14	8	18-10047-8	18-20092	18-20096-8	1-1/4 1-1/2	18-17510-8 18-17610-8

*Must use knockout adapter 18-20033

300 SERIES PREMIUM (EJECTOR) WATER COOLED ELECTRODE HOLDERS

CMW Premium holder barrels are made from high strength RWMA CLASS 2 material, centerless ground within .002" tolerance on diameter and nickel plated to resist wear and assure uniform contact resistance of a low magnitude.



300 SERIES TAPERED HOLDER					
Part No. Holder Assy.	Major Taper Dia. A	Barrel Dia. B	Barrel Length C	RW Taper D	Engagement With Std. Elect. E
18-317 18-318	.625	1-1/4 1-1/2	8	5 RW	3/4
18-319* 18-320*	.875	1-1/4 1-1/2		7 RW	1-1/8
18-337 18-338	.625	1-1/4 1-1/2	12	5 RW	3/4
18-339* 18-340*	.875	1-1/4 1-1/2		7 RW	1-1/8

*Must use knockout adapter 18-20033

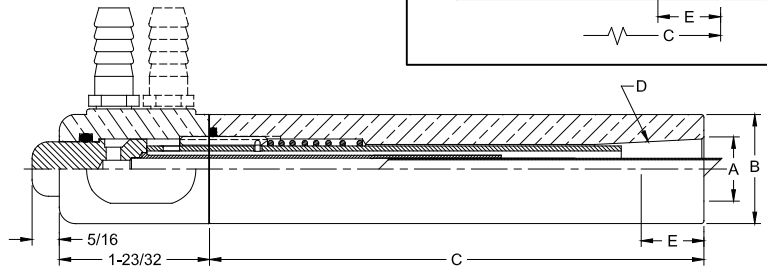
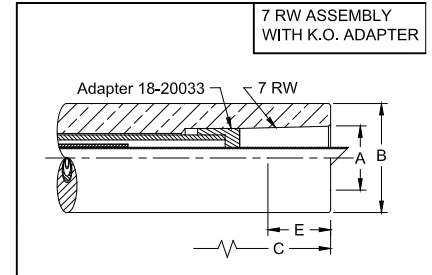
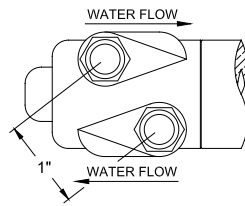

300 SERIES THREADED HOLDER				
Part No. Holder Assy.	Barrel Dia. B	Barrel Length C	Thread Size D	Engagement With Std. Elect. E
18-372 18-373	1 1-1/4	8	7/8-14	9/16
18-375 18-376	1-1/4 1-1/2		1-14	3/4

300 Series Threaded Holder can use Male Threaded to Female Taper Universal Adapters on page 46.

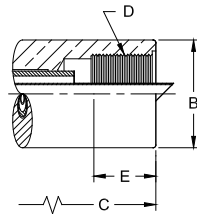

Note: These threaded holder barrels are the same as on 600 series holders on page 44.

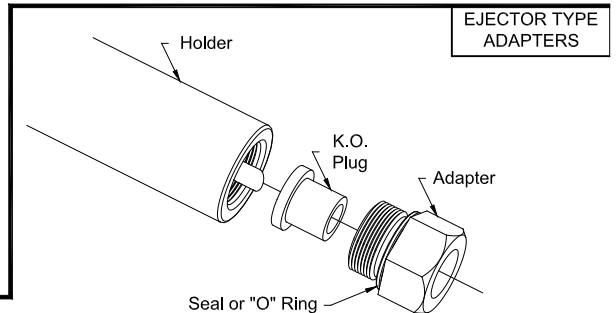

EJECTOR TYPE ADAPTERS

EJECTOR TYPE ADAPTERS 7/8-14 THREAD								
Adapter Part No.	Male Thd. Size L	Female Taper		Length Under Hd. M	Hex. Over Flats H	Overall Length C	Sealing Ring Part No.	K.O. Plug Part No.
		Size D	Major Dia.					
18-7702	7/8-14	4 RW	.463	5/8	1	13/16	18-76460	18-78501
18-7712	7/8-14	5 RW	.625	1/2	1	1-1/16	18-76460	18-7712-3

Use with Threaded Ejector Holder to make Replaceable Taper Holders

Part No.	Female Thd. Size	Barrel Dia.
18-372	7/8-14	1
18-373	7/8-14	1-1/4

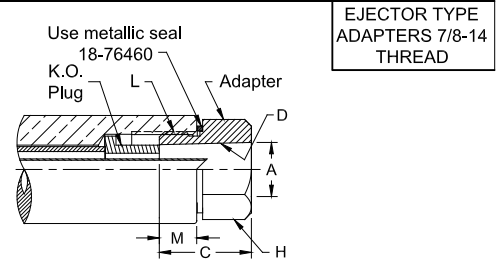

EJECTOR TYPE ADAPTERS 1-14 THREAD								
Adapter Part No.	Male Thd. Size L	Female Taper		Length Under Hd. M	Hex. Over Flats H	Overall Length C	Sealing Ring Part No.	K.O. Plug Part No.
		Size D	Major Dia.					
18-7852 18-7862	1-14 1-14	4 RW 5 RW	.463 .625	9/16 7/16	1-1/4 1-1/4	13/16 1-1/16	18-10060-17	18-78501 18-7712-3
18-7864 18-7872	1-14 1-14	6 RW 7 RW	.750 .875	3/4 3/4	1-1/4 1-1/4	1-3/4 2-1/8	18-10060-17	18-78650 18-78701

Use with Threaded Ejector Holder to make Replaceable Taper Holders

Part No.	Female Thd. Size	Barrel Dia.
18-375	1-14	1-1/4
18-376	1-14	1-1/2

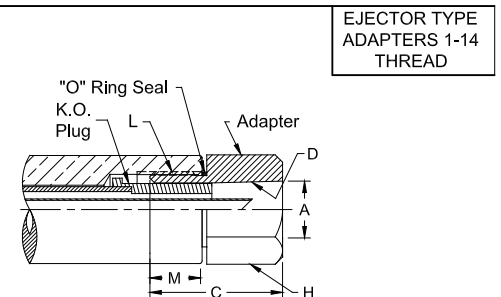

300 SERIES PREMIUM (EJECTOR) REPLACEMENT PARTS

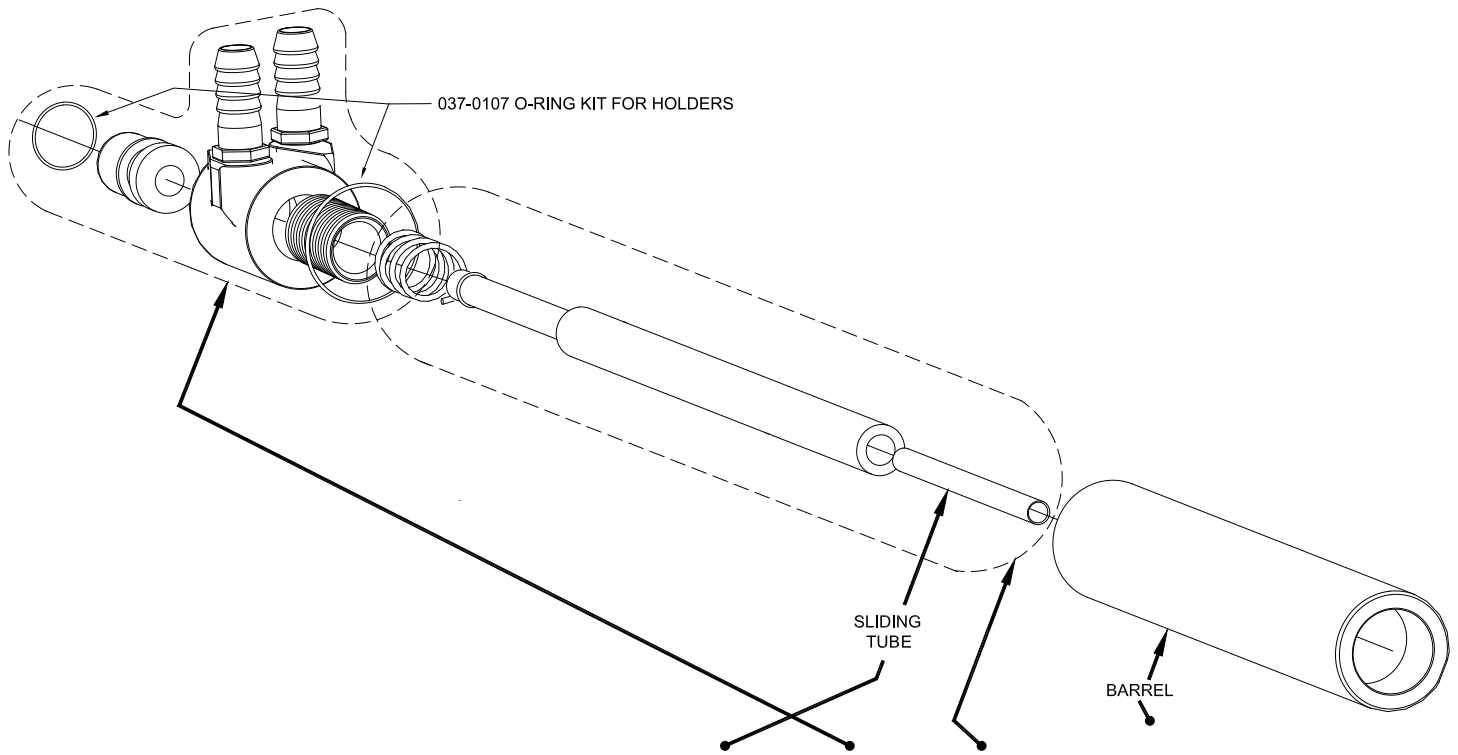

Part No. Holder Assy.	Thread Or Taper	O.A.L	Sliding Tube	Water Conn. HD. Sub-Assy.	K.O. Tube Sub-Assy	Barrel Diameter	Barrel
18-317 18-318	5 RW	8	18-10047-8	18-20092	18-20096-8	1-1/4 1-1/2	18-31710-8 18-31810-8
18-319* 18-320*	7 RW	8	18-10047-8	18-20092	18-20096-58	1-1/4 1-1/2	18-31910-8 18-32010-8
18-337 18-338	5 RW	12	18-10047-8	18-20092	18-20096-12	1-1/4 1-1/2	18-31710-12 18-31810-12
18-339* 18-340*	7 RW	12	18-10047-8	18-20092	18-20096-62	1-1/4 1-1/2	18-31910-12 18-32010-12
18-372 18-373	7/8-14	8	18-10047-8	18-20092	18-20096-8	1 1-1/4	18-37210-8 18-37310-8
18-375 18-376	1-14	8	18-10047-8	18-20092	18-20096-8	1-1/4 1-1/2	18-37510-8 18-37610-8

*Must use knockout adapter 18-20033

TYPICAL SET-UP COMBINATIONS USING CMW WELDING PRODUCTS

COMBINATIONS OF CMW HOLDERS, ADAPTERS AND ELECTRODES CAN PERFORM MOST RESISTANCE WELDING APPLICATIONS

Many of these combinations make possible welding operations that could have been done heretofore only by the use of "expensive and special" holders and electrodes. A few ideas of the many possible combinations are shown for your guidance.

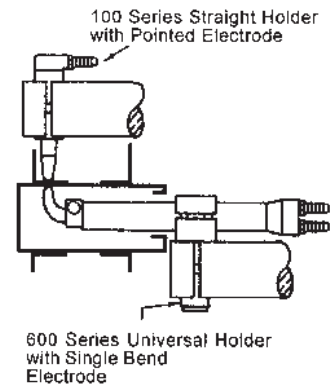
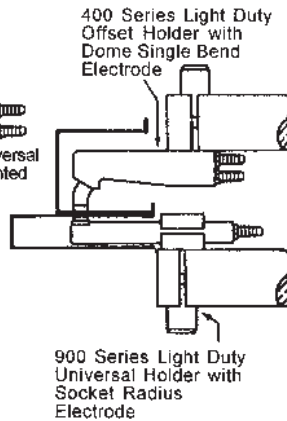
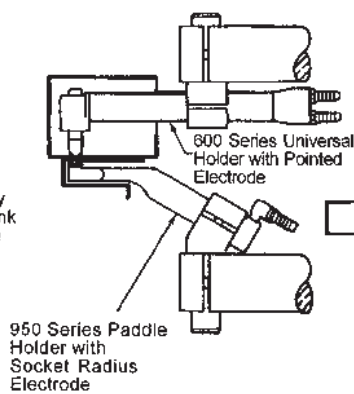
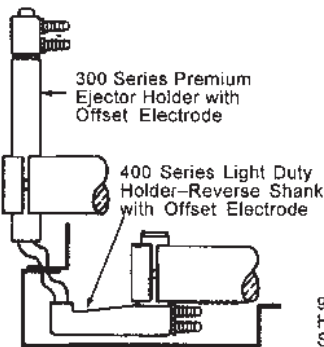
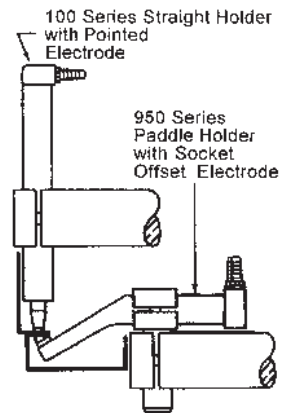
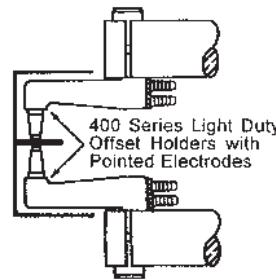
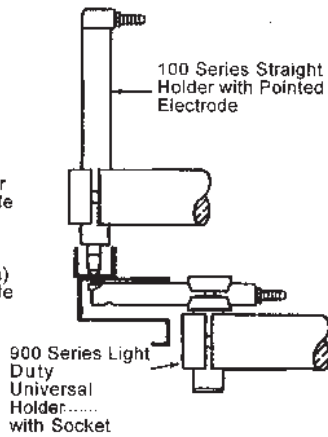
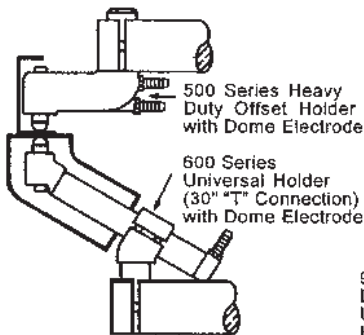
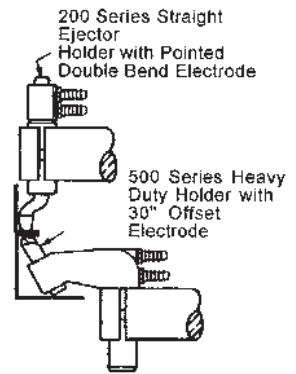
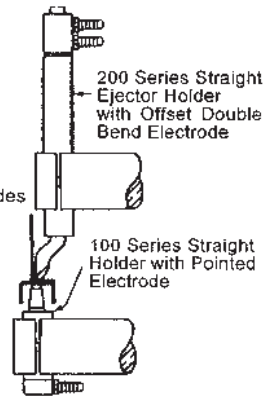
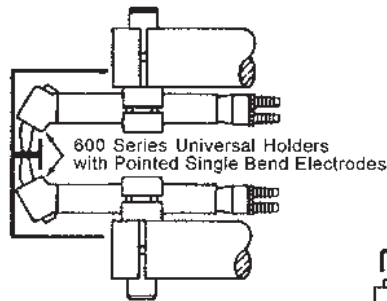
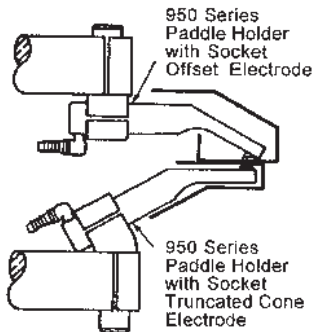
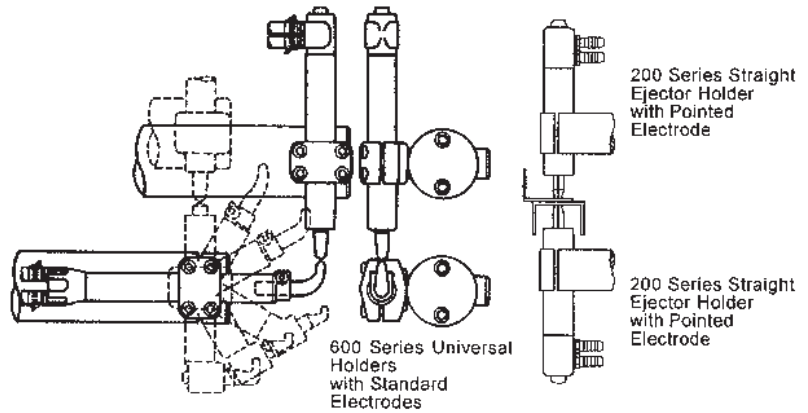

400 SERIES OFFSET (NON-EJECTOR) WATER COOLED ELECTRODE HOLDERS

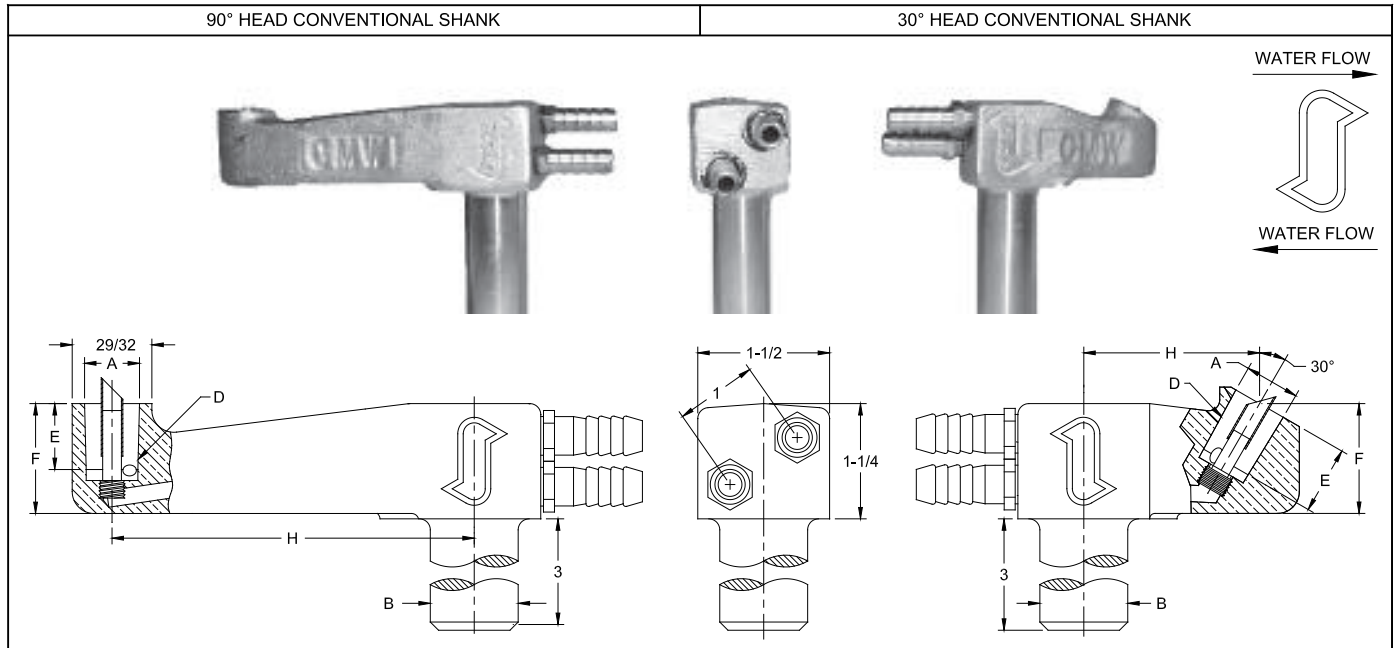

400 SERIES OFFSET HOLDER (CONVENTIONAL SHANK 90°)						
Part No. Holder Assy.	Major Taper Dia. A*	Shank Dia. B*	RW Taper D	Engagement With Electrode E	Head Height F	Offset H
18-402	.463	7/8	4 RW	1/2	1-1/16	2
18-403		1				
18-404		1-1/4				
18-407	.625	7/8	5 RW	3/4	1-1/4	2
18-408		1				
18-409		1-1/4				
18-422	.463	7/8	4 RW	1/2	1-1/16	4
18-423		1				
18-424		1-1/4				
18-428	.625	1	5 RW	3/4	1-1/4	4
18-429		1-1/4				

400 SERIES OFFSET HOLDER (CONVENTIONAL SHANK 30°)						
Part No. Holder Assy.	Major Taper Dia. A*	Shank Dia. B*	RW Taper D	Engagement With Electrode E	Head Height F	Offset H
18-442	.463	7/8	4 RW	1/2	1	2
18-443		1				
18-444		1-1/4				
18-448	.625	1	5 RW	3/4	1-1/4	2
18-449		1-1/4				
18-462	.463	7/8	4 RW	1/2	1	4
18-463		1				
18-464		1-1/4				
18-468	.625	1	5 RW	3/4	1-1/4	4
18-469		1-1/4				

*Other shank diameters and lengths or tapers available on special order

*Other shank diameters and lengths or tapers available on special order

400 SERIES OFFSET (NON-EJECTOR) WATER COOLED ELECTRODE HOLDERS

90° HEAD REVERSE SHANK

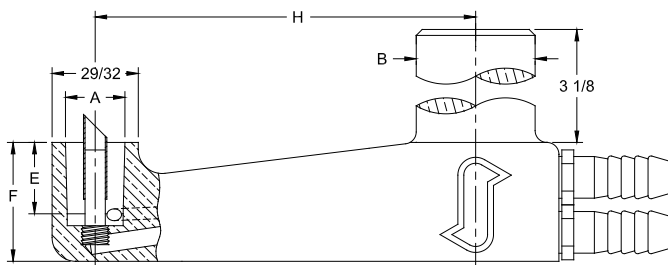

400 SERIES OFFSET HOLDER (REVERSE SHANK 90°)						
Part No. Holder Assy.	Major Taper Dia. A*	Shank Dia. B*	RW Taper D	Engagement With Electrode E	Head Height F	Offset H
18-433	.463	1	4 RW	1/2	1-1/16	4
18-439		1-1/4	5 RW	3/4	1-1/4	4

*Other shank diameters and lengths or tapers available on special order



400 SERIES OFFSET (NON-EJECTOR) REPLACEMENT PARTS

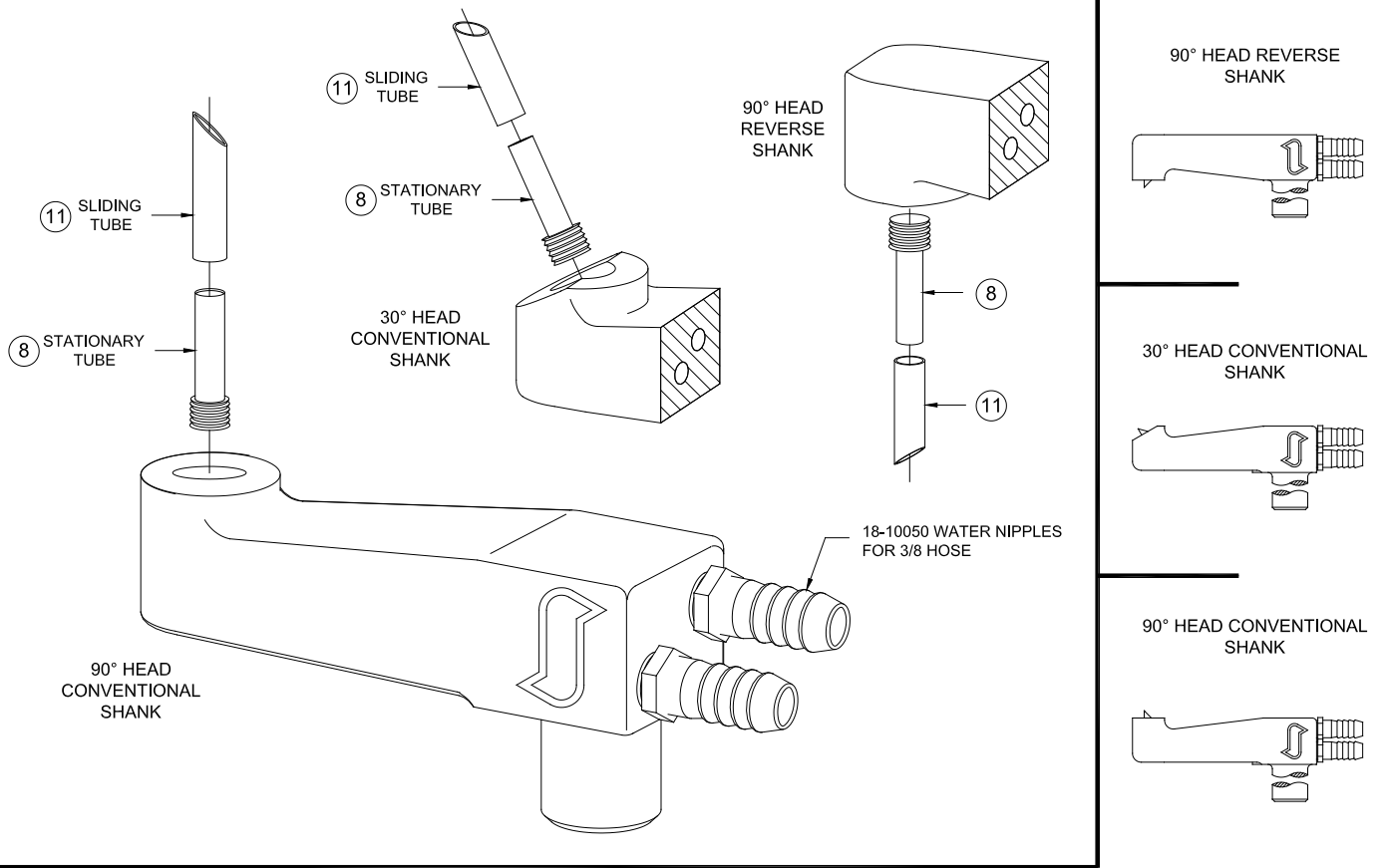

Part No. Holder Assy.	Taper	Angle Of Head	Stationary Tube 8	Sliding Tube 11	Shank Dia.
18-402 18-403 18-404	4 RW	90°	18-40041-1	18-40043-1	7/8 1 1-1/4
18-407 18-408 18-409	5 RW	90°	18-40041-1	18-40043-2	7/8 1 1-1/4
18-422 18-423 18-424 18-433*	4 RW	90°	18-40041-1	18-40043-1	7/8 1 1-1/4 1
18-428 18-429 18-439*	5 RW	90°	18-40041-1	18-40043-2	1 1-1/4 1-1/4
18-442 18-443 18-444	4 RW	30°	18-40041-1	18-40043-1	7/8 1 1-1/4
18-448 18-449	5 RW	30°	18-40041-1	18-40043-2	1 1-1/4
18-462 18-463 18-464	4 RW	30°	18-40041-1	18-40043-1	7/8 1 1-1/4
18-468 18-469	5 RW	30°	18-40041-1	18-40043-2	1 1-1/4

*Reverse shank

500 SERIES PREMIUM (EJECTOR) WATER COOLED OFFSET HOLDERS

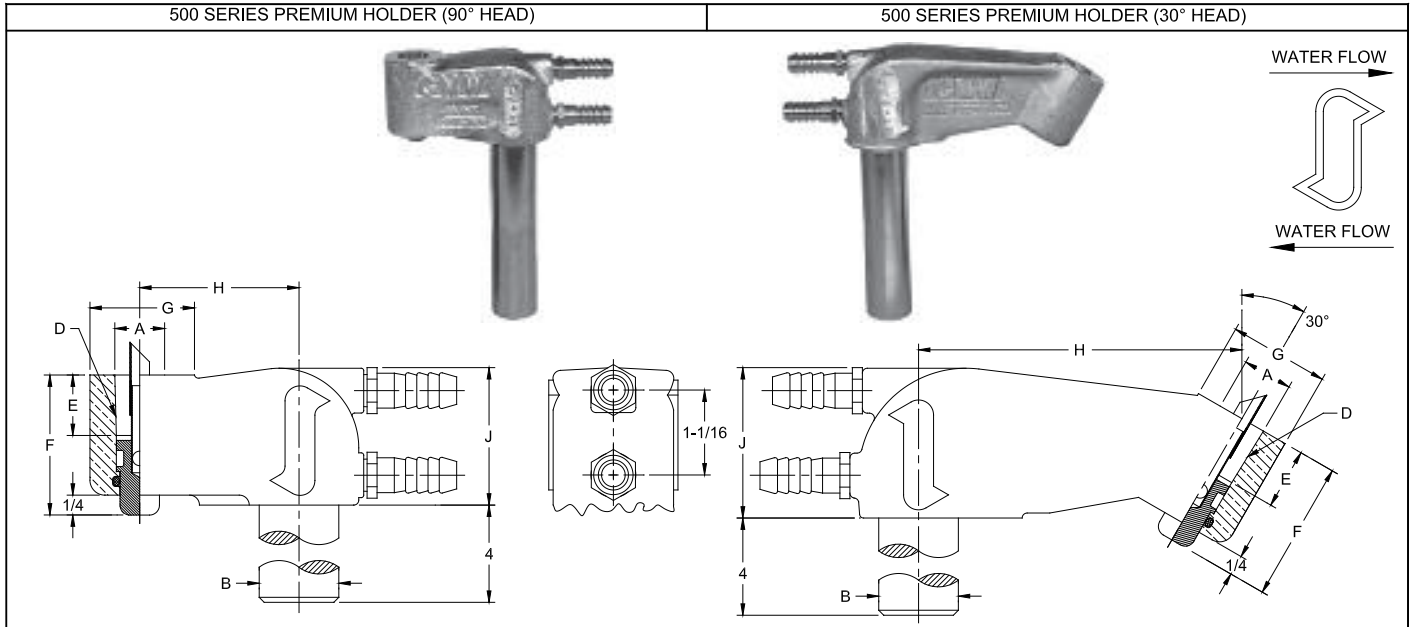

500 SERIES PREMIUM HOLDER (90° HEAD)								
Part No. Holder Assy.	Major Taper Dia. A*	Shank Dia. B*	RW Taper D	Engagement With Electrode E	Head Height F	Head Dia. G	Offset H	Head Thickness J
18-502		1						
18-503	.625	1-1/4	5 RW	3/4	1-13/16	1-1/4	2	1-23/32
18-504		1-1/2						
18-505	.875	1-1/4	7 RW	1-1/8	2-7/32	1-1/2	2	1-23/32
18-506		1-1/2						
18-522	.625	1	5 RW	3/4	1-13/16	1-1/4	4	1-7/8
18-523		1-1/4						
18-524		1-1/2						
18-525	.875	1-1/4	7 RW	1-1/8	2-7/32	1-1/2	4	1-7/8
18-526		1-1/2						

*Other shank diameters and lengths or tapers available on special order

500 SERIES PREMIUM HOLDER (30° HEAD)								
Part No. Holder Assy.	Major Taper Dia. A*	Shank Dia. B*	RW Taper D	Engagement With Electrode E	Head Height F	Head Dia. G	Offset H	Head Thickness J
18-562		1						
18-563	.625	1-1/4	5 RW	3/4	1-13/16	1-5/16	4	1-7/8
18-564		1-1/2						
18-565	.875	1-1/4	7 RW	1-1/8	2-7/32	1-9/16	4	1-7/8
18-566		1-1/2						

*Other shank diameters and lengths or tapers available on special order

500 SERIES PREMIUM (EJECTOR) WATER COOLED ELECTRODE HOLDERS WITH THREADED ADAPTERS

500 SERIES PREMIUM HOLDER WITH THREADED ADAPTERS										
Part No. Holder Assy.	Head Angle	Major Taper Dia. A*	Shank Dia. B*	RW Taper D	Engagement With Electrode E	Head Height F	Head Dia. G	Offset H	Head Thickness J	Part No. Threaded Adapter
18-5035	90°	.625	1-1/4	5 RW	3/4	1-13/16	1-1/4	2	1-23/32	18-7875
18-5036		.750		6 RW	7/8	1-15/16				18-7876
18-5045	90°	.625	1-1/2	5 RW	3/4	1-13/16	1-1/4	2	1-23/32	18-7875
18-5046		.750		6 RW	7/8	1-15/16				18-7876
18-5235	90°	.625	1-1/4	5 RW	3/4	1-13/16	1-1/4	4	1-7/8	18-7875
18-5236		.750		6 RW	7/8	1-15/16				18-7876
18-5245	90°	.625	1-1/2	5 RW	3/4	1-13/16	1-1/4	4	1-7/8	18-7875
18-5246		.750		6 RW	7/8	1-15/16				18-7876
18-5635	30°	.625	1-1/4	5 RW	3/4	1-13/16	1-1/4	4	1-7/8	18-7875
18-5636		.750		6 RW	7/8	1-15/16				18-7876
18-5645	30°	.625	1-1/2	5 RW	3/4	1-13/16	1-1/4	4	1-7/8	18-7875
18-5646		.750		6 RW	7/8	1-15/16				18-7876

*Other shank diameters and lengths or tapers available on special order

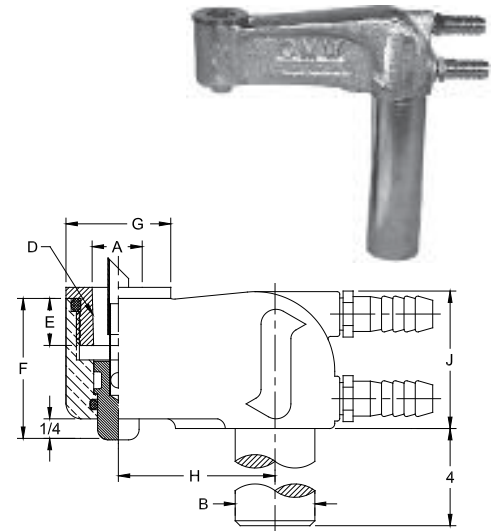

500 SERIES PREMIUM (EJECTOR) REPLACEMENT PARTS

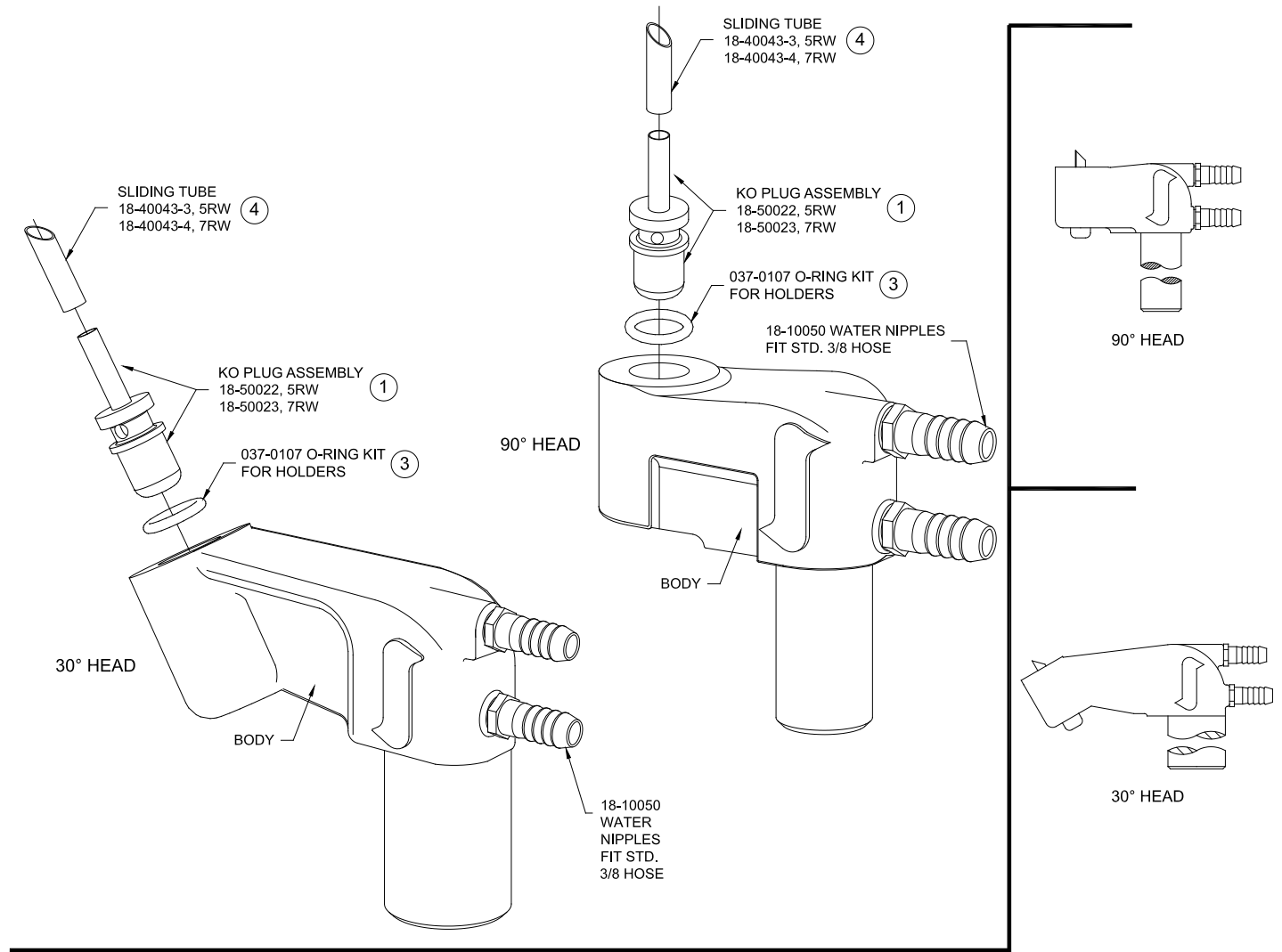

Part No. Holder Assy.	Taper	Angle Of Head	KO Plug Assembly 1	Sealing Ring 3	Sliding Tube 4	Shank Dia.
18-502 18-503 18-504	5 RW	90°	18-50022	18-10060-10	18-40043-3	1 1-1/4 1-1/2
18-505 18-506	7 RW	90°	18-50023	18-10060-12	18-40043-4	1-1/4 1-1/2
18-522 18-523 18-524	5 RW	90°	18-50022	18-10060-10	18-40043-3	1 1-1/4 1-1/2
18-525 18-526	7 RW	90°	18-50023	18-10060-12	18-40043-4	1-1/4 1-1/2
18-562 18-563 18-564	5 RW	30°	18-50022	18-10060-10	18-40043-3	1 1-1/4 1-1/2
18-565 18-566	7 RW	30°	18-50023	18-10060-12	18-40043-4	1-1/4 1-1/2

500 SERIES THREADED PREMIUM (EJECTOR) REPLACEMENT PARTS

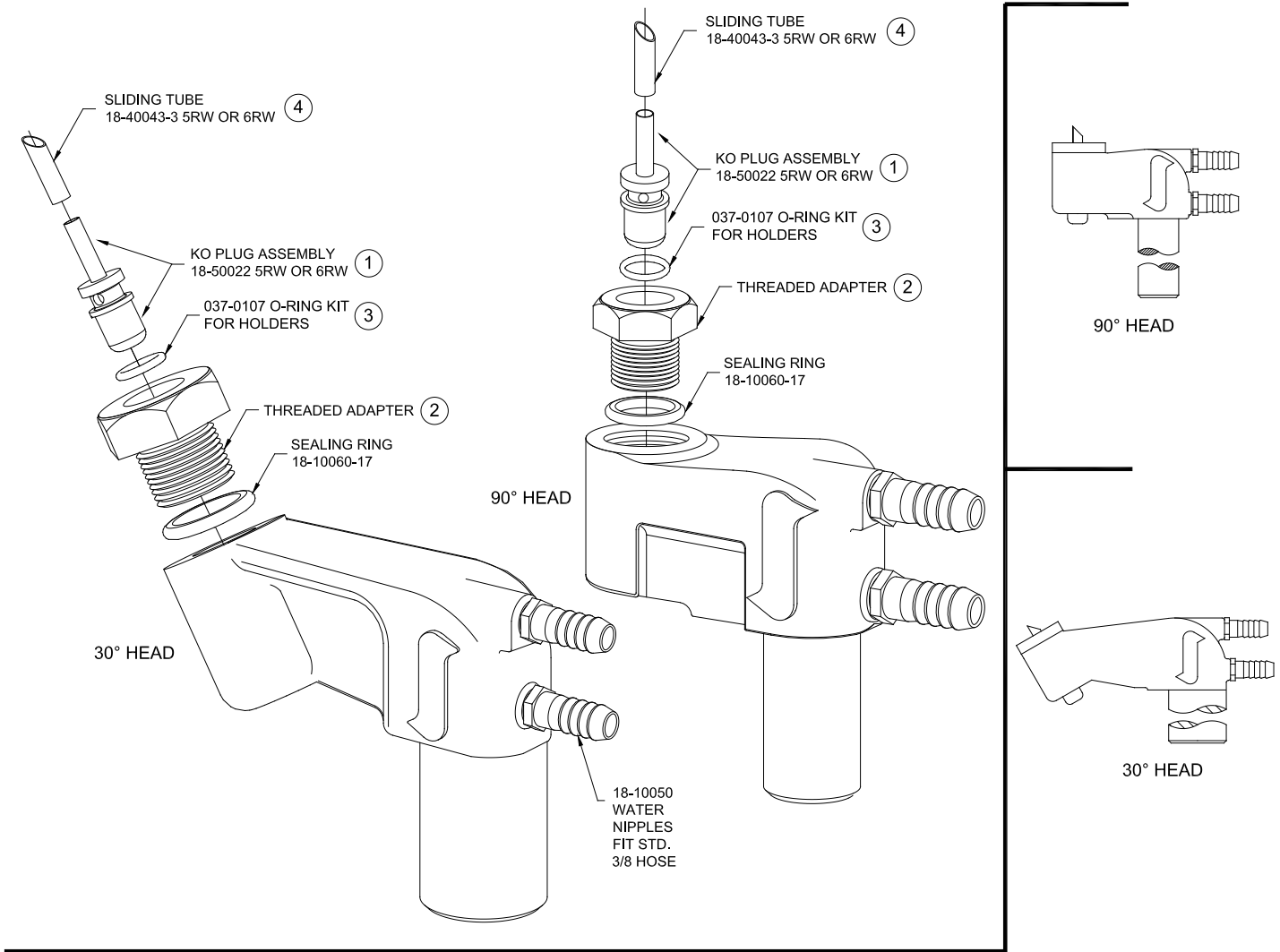

Part No. Holder Assy.	Taper	Angle Of Head	KO Plug Assembly 1	Sealing Ring 3	Sliding Tube 4	Shank Dia.	Threaded Adapter 2
18-5035 18-5036	5 RW 6 RW	90°	18-50022	18-10060-10	18-40043-3	1-1/4	18-7875 18-7876
18-5045 18-5046	5 RW 6 RW	90°	18-50022	18-10060-10	18-40043-3	1-1/2	18-7875 18-7876
18-5235 18-5236	5 RW 6 RW	90°	18-50022	18-10060-10	18-40043-3	1-1/4	18-7875 18-7876
18-5245 18-5246	5 RW 6 RW	90°	18-50022	18-10060-10	18-40043-3	1-1/2	18-7875 18-7876
18-5635 18-5636	5 RW 6 RW	30°	18-50022	18-10060-10	18-40043-3	1-1/4	18-7875 18-7876
18-5645 18-5646	5 RW 6 RW	30°	18-50022	18-10060-10	18-40043-3	1-1/2	18-7875 18-7876

600 SERIES UNIVERSAL WATER COOLED ELECTRODE HOLDERS

EXAMPLE: This is shown with standard 90° adapter head and 600 series water connector body 18-74001 "Type A"

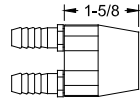
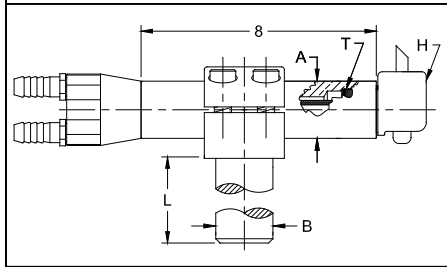

TYPE (A)
600 Series Water Connector Body 18-74001

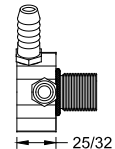

TYPE (C)
100 Series Water Connector Body 18-10042

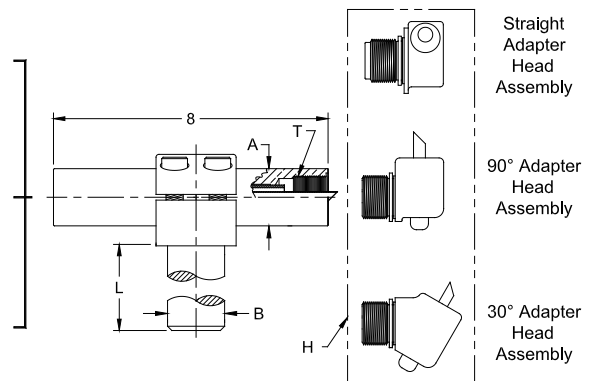

*Standard holders include type "A" water connector, types "B" and "C" available on request
See page 46 for adapter head details and page 47 for additional "T" connector information.

600 SERIES UNIVERSAL HOLDER (90° ADAPTER HEAD)						
Part No. Holder Assy.*	Taper	Barrel Dia. A	Shank Dia. B	Shank Length L	Head Assy. H	Barrel Thread Size T
18-601	5 RW	1	7/8	3	18-764	7/8-14
18-603		1	1	3		
18-605	5 RW	1-1/4	1-1/4	3-1/2	18-764	7/8-14
18-607		1-1/4	1-1/2	4		
18-611	5 RW	1	7/8	3	18-766	7/8-14
18-613		1	1	3		
18-615	5 RW	1-1/4	1-1/4	3-1/2	18-766	7/8-14
18-617		1-1/2	1-1/2	4		
18-651	5 RW	1-1/4	1-1/4	3-1/2	18-780	1-14
18-657		1-1/4	1-1/2	4		
18-655	5 RW	1-1/2	1-1/4	4	18-780	1-14
18-653		1-1/2	1-1/2	4		
18-661	7 RW	1-1/4	1-1/4	3-1/2		
18-665		1-1/2	1-1/4	4	18-782	1-14
18-663		1-1/2	1-1/2	4		



600 SERIES UNIVERSAL HOLDER (STRAIGHT ADAPTER HEAD)						
Part No. Holder Assy.*	Taper	Barrel Dia. A	Shank Dia. B	Shank Length L	Head Assy. H	Barrel Thread Size T
18-621	4 RW	1	7/8	3	18-768	7/8-14
18-622		1	1	3		
18-623	4 RW	1-1/4	1-1/4	3-1/2	18-768	7/8-14
18-671		1-1/4	1-1/4	3-1/2	18-784	1-14
18-624	5 RW	1-1/4	1-1/2	4	18-768	7/8-14
18-674		1-1/4	1-1/2	4	18-784	1-14
18-672	5 RW	1-1/2	1-1/2	4	18-784	1-14
18-673		1-1/2	1-1/4	4		

600 SERIES UNIVERSAL HOLDER (30° ADAPTER HEAD)						
Part No. Holder Assy.*	Taper	Barrel Dia. A	Shank Dia. B	Shank Length L	Head Assy. H	Barrel Thread Size T
18-602	4 RW	1	7/8	3	18-765	7/8-14
18-604		1	1	3		
18-606	4 RW	1-1/4	1-1/4	3-1/2	18-765	7/8-14
18-608		1-1/4	1-1/2	4		
18-612	5 RW	1	7/8	3	18-767	7/8-14
18-614		1	1	3		
18-616	5 RW	1-1/4	1-1/4	3-1/2	18-767	7/8-14
18-618		1-1/4	1-1/2	4		
18-652	5 RW	1-1/4	1-1/4	3-1/2	18-781	1-14
18-658		1-1/4	1-1/2	4		
18-656	5 RW	1-1/2	1-1/4	4	18-781	1-14
18-654		1-1/2	1-1/2	4		
18-662	7 RW	1-1/4	1-1/4	3-1/2		
18-666		1-1/2	1-1/4	4	18-783	1-14
18-664		1-1/2	1-1/2	4		

600 SERIES UNIVERSAL WATER COOLED ELECTRODE HOLDER (THREADED ADAPTER HEAD)

600 SERIES UNIVERSAL HOLDER (THREADED ADAPTER HEAD)							
Part No. Holder Assy.*	Taper	Head Angle	Barrel Dia. A	Shank Dia. B	Shank Length L	Head Assy. H	Barrel Thread Size T
18-6515	5 RW	90°	1-1/4	1-1/4	3-1/2	18-7805	1-14
18-6535		30°	1-1/2	1-1/2	4		
18-6525	5 RW	30°	1-1/4	1-1/4	3-1/2	18-7815	1-14
18-6545		30°	1-1/2	1-1/2	4		
18-6516	6 RW	90°	1-1/4	1-1/4	3-1/2	18-7806	1-14
18-6536		30°	1-1/2	1-1/2	4		
18-6526	6 RW	30°	1-1/4	1-1/4	3-1/2	18-7816	1-14
18-6546		30°	1-1/2	1-1/2	4		

*Standard holders include type "A" water connector, types "B" and "C" available on request

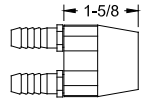

TYPE (A)
600 Series Water Connector Body 18-74001

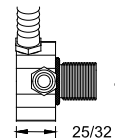

TYPE (C)
100 Series Water Connector Body 18-10042

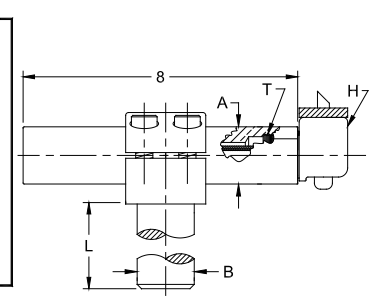

Main: 844-WSI-WELD · International: +1-216-475-5629

www.wsiweld.com



600 SERIES UNIVERSAL REPLACEMENT PARTS

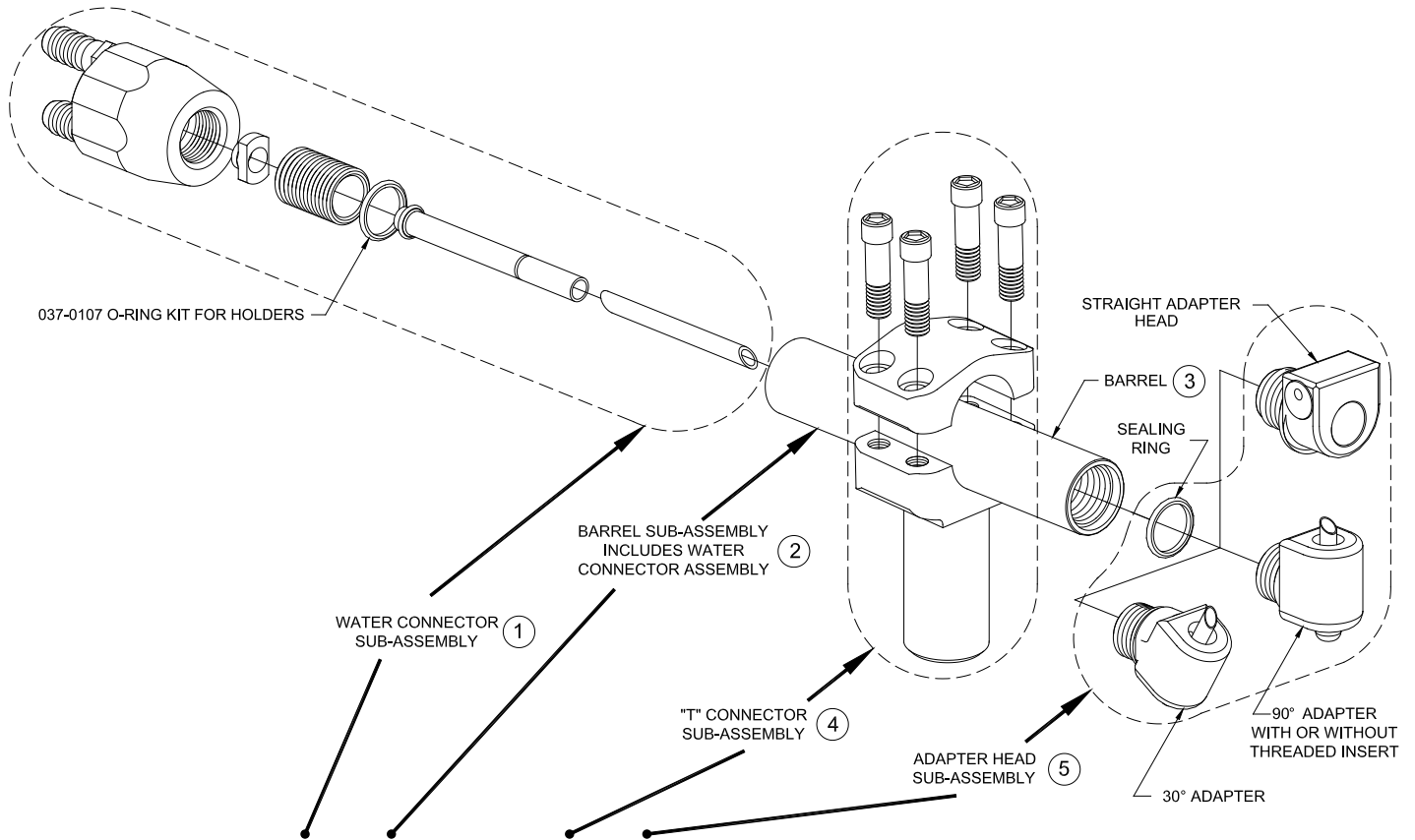

Part No. Holder Assy.	Taper	Angle Of Head	Water Conn. Assembly 1	Barrel Assy. 2	Barrel 3	"T" Conn. Assy.* 4	Adapter Head Assy.* 5	
18-601 18-602	4 RW	90°	18-74000-8	18-701	18-37210-8	18-725	18-764	
18-603 18-604		30°					18-765	
18-605 18-606		90°	18-74000-8	18-702	18-37310-8	18-727	18-764	
18-607 18-608		30°					18-765	
18-611 18-612	5 RW	90°	18-74000-8	18-701	18-37210-8	18-725	18-766	
18-613 18-614		30°					18-767	
18-615 18-616		90°	18-74000-8	18-702	18-37310-8	18-727	18-766	
18-617 18-618		30°					18-767	
18-621 18-622		STR. STR.	18-74000-8	18-701	18-37210-8	18-725 18-726	18-768	
18-623 18-624		STR. STR.						18-702
18-651 18-652		90°	18-74000-8	18-704	18-37510-8	18-727	18-780	18-781
18-657 18-658		30°						18-781

Part No. Holder Assy.	Taper	Angle Of Head	Water Conn. Assembly* 1	Barrel Assy. 2	Barrel 3	"T" Conn. Assy.* 4	Adapter Head Assy.* 5			
18-655 18-656	5 RW	90°	18-74000-8	18-705	18-37610-8	18-728	18-780			
18-653 18-654		30°					18-729	18-781		
18-671 18-672		STR. STR.	18-74000-8	18-704	18-37510-8	18-727	18-784			
18-673 18-674		STR. STR.		18-705	18-37610-8	18-728	18-784			
18-6515 18-6525	5 RW THD.	90°	18-74000-8	18-704	18-37510-8	18-727	18-7805			
18-6535 18-6545		30°					18-705	18-37610-8	18-729	18-7815
18-6516 18-6526		90°					18-74000-8	18-704	18-37510-8	18-727
18-6536 18-6546	30°	18-705	18-37610-8	18-729	18-7816					
18-661 18-662	7 RW	90°	18-74000-8	18-704	18-37510-8	18-727	18-782			
18-665 18-666		30°					18-705	18-37610-8	18-728	18-783
18-663 18-664		90°	18-74000-8	18-705	18-37610-8	18-729	18-782			
		30°					18-783			

* See page 46 for adapter head details and page 47 for additional "T" connector information.

900 SERIES UNIVERSAL & 950 SERIES PADDLE WATER COOLED HOLDERS

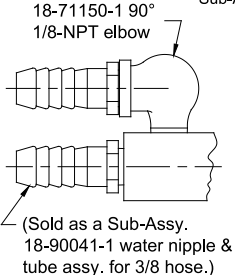
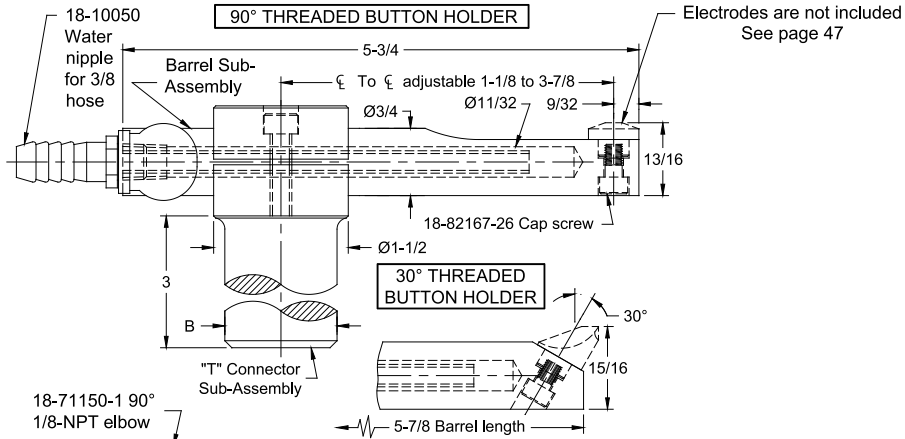

Holder Type	Holder Assembly Part No.	Holder Angle	Shank Dia. B	Barrel Sub-Assy.	Barrel	"T" Conn.
Threaded Button	18-901	90°	3/4	18-709	18-70910-1	18-720
	18-902	30°		18-710	18-71010-1	
	18-903	90°	7/8	18-709	18-70910-1	18-721
	18-904	30°		18-710	18-71010-1	
	18-905	90°	1	18-709	18-70910-1	18-722
	18-906	30°		18-710	18-71010-1	
	18-907	90°	1-1/4	18-709	18-70910-1	18-723
	18-908	30°		18-710	18-71010-1	
	18-909	90°	1-1/2	18-709	18-70910-1	18-724
	18-900	30°		18-710	18-71010-1	

950 SERIES WATER COOLED PADDLE HOLDERS FOR THREADED BUTTON ELECTRODES

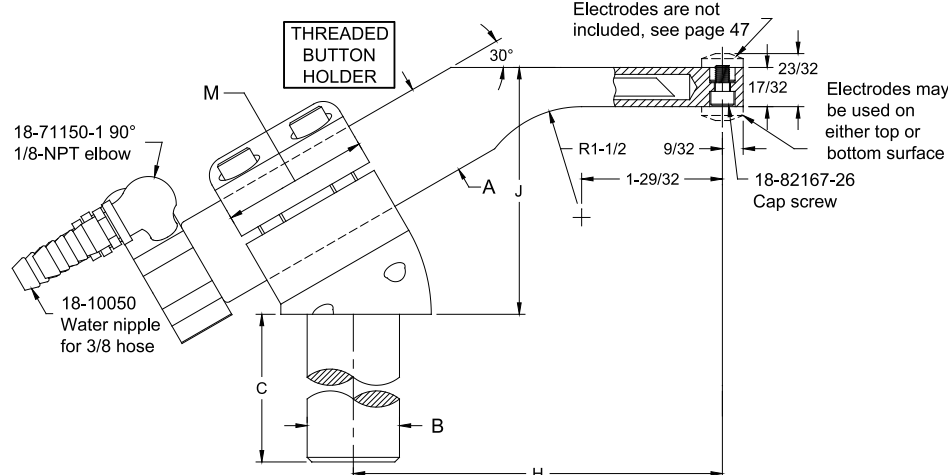

Holder Type	Holder Assembly Part No.	Barrel Dia. A	Shank Dia. B	Shank Length C	Offset Range H	Height Range J	Width M	Barrel Sub-Assy.	"T" Conn.
Threaded Button	18-952	1	7/8	3	3-3/8 to 5-3/32	2-1/16 to 3-1/16	1-1/2	18-713	18-731
	18-953		1					18-713	18-732
	18-954	1-1/4	1-1/4	3-1/2	4 to 5-23/32	2-3/4 to 3-3/4	1-3/4	18-714	18-733
	18-955	1-1/2	1-1/2	4	4-7/32 to 5-15/16	2-7/8 to 3-7/8	2	18-715	18-734

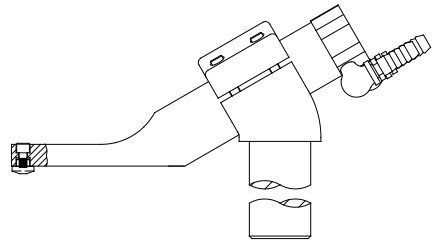

VIEW IS SHOWING BARREL SUB-ASSY AND ELECTRODE REVERSED IN SHANK

PLATEN MOUNTED ELECTRODE HOLDERS

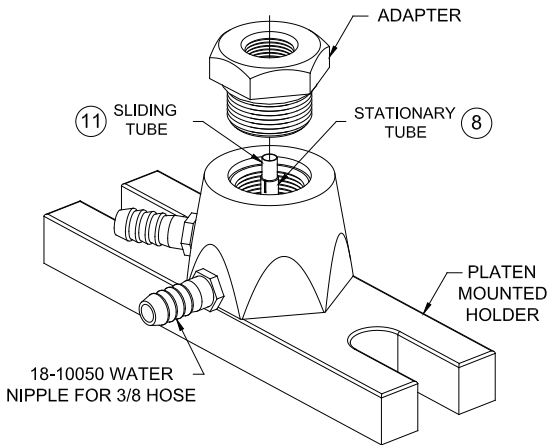

The CMW Platen Mounted Holder, as shown below, has the inlet water nipple at position #1 and the outlet water nipple at position #2, any other combinations may be special ordered by changing the last two digits of the part number. The first of the last two digits indicates the location of the inlet nipple and the second digit indicates the location of the outlet nipple. Example; part No. 18-0510-56 would place the inlet water nipple at position #5 and the outlet water nipple at position #6.

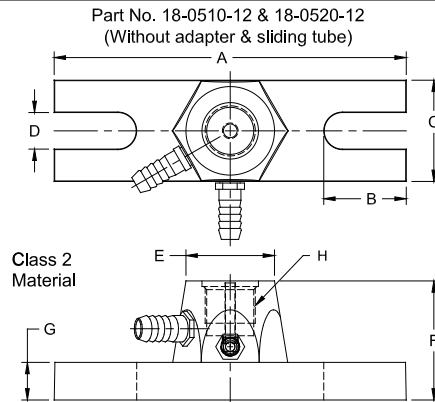
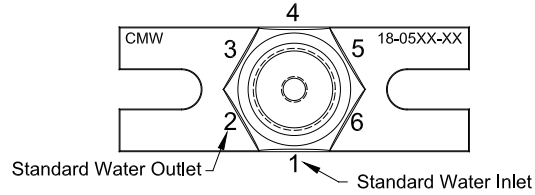

Order one of each for your application		Attachment Type	Stationary Tube 8	Order as required		Overall Length A	Slot Depth B	Width C	Slot Width D	Top Dia. E	Overall Height F	Base Height G	Thread H
Holder Part No.	Adapter Part No.			Sliding Tube 11	Sliding Length								
18-0510-12	18-785	4RW	18-40041-5	18-50041-3 18-50041-2	1-3/8 2-1/2	4-1/4	1	1-1/2	1/2	1-23/64	2-1/8	1/2	1-14 UNF
18-0520-12	18-785	4RW	18-40041-5	18-50041-3 18-50041-2	1-3/8 2-1/2	7	1-5/8	2	3/4	1-49/64	2-3/8	3/4	
18-0510-12	18-786	5RW	18-40041-5	18-40043-11 18-40043-5 18-40043-9	1-3/8 2 4	4-1/4	1	1-1/2	1/2	1-23/64	2-1/8	1/2	
18-0520-12	18-786	5RW	18-40041-5	18-40043-11 18-40043-5 18-40043-9	1-3/8 2 4	7	1-5/8	2	3/4	1-49/64	2-3/8	3/4	
18-0510-12	18-7863	6RW	18-40041-5	18-40043-14 18-40043-9	2-1/8 4	4-1/4	1	1-1/2	1/2	1-23/64	2-1/8	1/2	
18-0520-12	18-7863	6RW	18-40041-5	18-40043-14 18-40043-9	2-1/8 4	7	1-5/8	2	3/4	1-49/64	2-3/8	3/4	
18-0510-12	18-787	7RW	18-40041-5	18-40043-15 18-40043-9	2-3/8 4	4-1/4	1	1-1/2	1/2	1-23/64	2-1/8	1/2	
18-0520-12	18-787	7RW	18-40041-5	18-40043-15 18-40043-9	2-3/8 4	7	1-5/8	2	3/4	1-49/64	2-3/8	3/4	
18-0510-12	18-812	#2 SIZE Nu-Twist®	18-40041-5	-	-	4-1/4	1	1-1/2	1/2	1-23/64	2-1/8	1/2	
	18-7743**	5/8-18 THD.											
18-0520-12	18-812	#2 SIZE Nu-Twist®	18-40041-5	-	-	7	1-5/8	2	3/4	1-49/64	2-3/8	3/4	
	18-7743**	5/8-18 THD.											

**Adapter for 1" dia. & 1-1/4 dia. Chameleon/Max-Life™ projection welding electrodes and 18-811 #1 size threaded "NU-TWIST"® adapter.